

Diaphragm-Type Chemical Seals

Welded Design, with Threaded Process Connection

Male Thread • Model 990.34

Chemical Seals

Service intended

Process industry chemical seal to combine with bourdon tube pressure gauges preferably up to size 100 mm dia.
Suitable for corrosive, contaminated or hot pressure media.

Design

Body parts welded together to enable extremely small dimensions, welded diaphragm

Process connection

Male thread

Pressure rating

PN 160,
PN 600 or
PN 1000

Suitable pressure ranges

for PN 160: 0 ... 0.6 bar to 0 ... 160 bar
for PN 600: 0 ... 100 bar to 0 ... 600 bar
for PN 1000: 0 ... 600 bar to 0 ... 1000 bar

Effective diameter d_M of diaphragm

for PN 160: $d_M = 52$ mm
for PN 600: $d_M = 32$ mm
for PN 1000: $d_M = 22$ mm

Standard features

Upper body (gauge side)

Stainless steel 1.4571
Gauge connection G ½ female per EN 837-1 / 7.3.5

Diaphragm

Stainless steel 1.4571
welded with upper body

Lower body (process side)

Stainless steel 1.4571
G ½ B (male) per EN 837-1 / 7.3, welded with upper body



Model 990.34, pressure rating PN 160



Model 990.34, pressure rating PN 600

Optional extras

Upper body (gauge side)

- Monel, Hastelloy
- capillary extension
- welded cooling tower for directly mounted gauge when temperature > 100 °C
- male thread G ¼

Diaphragm

- Monel, Hastelloy

Lower body (process side)

- Monel, Hastelloy
- male or female thread, G ½, ½ NPT (other possible)

Dimensions

Standard version

Model 990.34, pressure rating PN 160

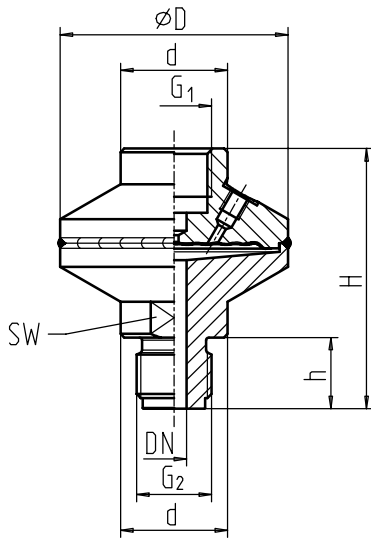

2259 193.01

Model 990.34, pressure rating PN 600

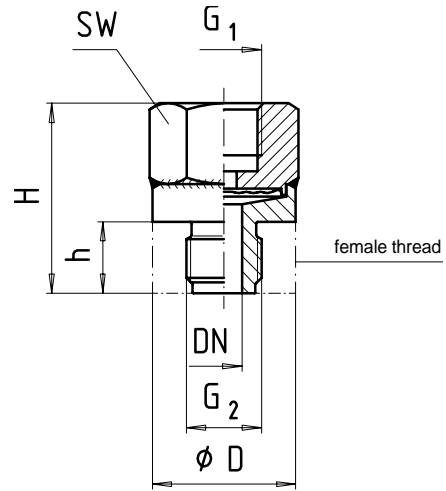

1342 355.01

PN [bar]	Dimensions [mm]								Weight [kg]
	D	d	DN	G ₁	G ₂	H	h	SW	
160	64	30	7	G ½	G ½ B	73	20	27	0.65
600	40	-	10	G ½	G ½ B	53	20	36	0.35

Ordering information

Specify:

Model / Size of connection / Filling liquid / Pressure instrument desired / Process conditions as per questionnaire / Optional extras required



INGENIEROS ASOCIADOS DE CONTROL S.L.

TelF.: 91 383 1390
comercial@iac-sl.es