

Flush Diaphragm Pressure Gauges

for Food , Biological and Pharmaceutical Industry

Model 432.55

Pressure Gauges

- Measuring system dry, no transmission liquid
- Wetted parts and covering metallic components made of stainless steel
- Hygienic-type connection for direct, fast installation and removal
- Suitable for CIP-facilities
- Scale ranges from 0 ... 0.6 bar to -1 ... 4 bar

General features

The pressure gauge model 432.55 was designed as an addition to WIKA's standard range of products in order to meet the special demands made on process connections in the food, biological and pharmaceutical industry as well as in the paint and lacquer sector.

All wetted parts are made of stainless steel and fully welded.

Due to the special design of the gauge it is possible to use an absolutely dry measuring cell, thus excluding a contamination of the medium with transmission liquids that may occur on chemical seal systems in the case of a damage to the diaphragm.

Design

EN 837-3

Nominal size

100 and 160 mm

Accuracy class per EN 837-3 /6

1.6

Working pressure

Steady: full scale value

Fluctuating: 0.9 x full scale value

Overpressure safety

1.5 x full scale value

Operating temperature

Ambient: -20 ... +60 °C

Medium: +150 °C maximum

Temperature error

Additional error when temperature of the pressure element deviates from +20 °C

Rising temperature: +0.5%/10 K of true scale value

Falling temperature: -0.5%/10 K of true scale value

Degree of protection

IP 54 per EN 60 529 / IEC 529



Standard features

Process connection (exposed to pressure medium)

Stainless steel 1.4435, 2" clamp, bottom connection

Pressure element (exposed to pressure medium)

Welded with process connection, stainless steel 1.4435

Movement

Material: stainless steel

Dial

White aluminium with black lettering

Pointer

Black aluminium pointer

Case

Stainless steel case with pressure vent in case back

Window

Laminated safety glass

Bezel ring

Cam ring (bayonet type), stainless steel

Optional extras

- Process connection clamp (from 2½") resp. thread connection per DIN 11 851, SMS-Standard, IDF-Standard or APV-RJT-Standard (from DN 50 resp. 2")
- Wetted parts and covering metallic components electropolished
- Wetted parts electropolished
- Liquid filling (**model 433.55**)
- Higher overpressure protection
- Connector position at 3, 9 or 12 o'clock
- Alarm contacts (see data sheet AE 08.01)

Dimensions

Clamp connection

| Process connection | DN [in.] | Dimensions [mm] | | | | | | Weight [kg] |
|--------------------|-------------|--------------------|-----|-------|---|------|----|----------------|
| | | D | h | Ø P1f | G | d | k | |
| Clamp | 2 | 100 | 85 | 48 | - | 64 | 15 | 0.65 |
| | | 160 | 115 | | | | | 1.05 |
| | 2 ½ | 100 | 85 | | - | 77.5 | 15 | 0.85 |
| | | 160 | 115 | | | | | 1.25 |
| | 3 | 100 | 85 | | - | 91 | 15 | 1.2 |
| | | 160 | 115 | | | | | 1.6 |

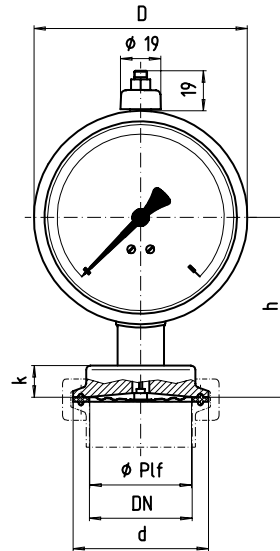

2223 554.01

Process connection with union nut

| Process connection | DN [mm or in.] | Dimensions [mm] | | | | | | Weight [kg] |
|--------------------|----------------------|--------------------|-----|---------|----------|-----|------|----------------|
| | | D | h | Ø P1f | G | d | k | |
| DIN 11 851 | 50 | 100 | 85 | 48 | Rd 78xD | 92 | 22 | 0.7 |
| | | 160 | 115 | | 1.1 | | | |
| | 80 | 100 | 92 | | Rd 110x¼ | 127 | 29 | 1.15 |
| | | 160 | 122 | | 1.55 | | | |
| SMS-Standard | 2 | 100 | 90 | Rd 70xD | 84 | 26 | 0.8 | |
| | | 160 | 120 | 1.2 | | | | |
| IDF-Standard | 2 | 100 | 92 | 2" IDF | 79 | 30 | 0.75 | |
| | | 160 | 122 | 1.15 | | | | |
| APV-RJT-Standard | 2 | 100 | 85 | 2H x6" | 86 | 22 | 0.75 | |
| | | 160 | 115 | 1.15 | | | | |

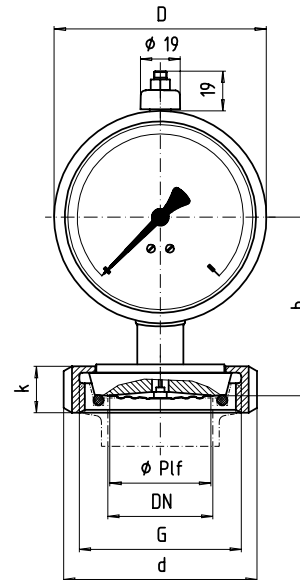

2223 311.01

Process connection with male thread

| Process connection | DN [mm or in.] | Dimensions [mm] | | | | | | Weight [kg] |
|--------------------|----------------------|--------------------|-----|--------|---------|----|-----|----------------|
| | | D | h | Ø P1f | G | d | k | |
| DIN 11 851 | 50 | 100 | 92 | 48 | Rd 78xD | 92 | 22 | 0.8 |
| | | 160 | 122 | | 1.2 | | | |
| SMS-Standard | 2 | 100 | 98 | | Rd 70xD | 84 | 26 | 0.9 |
| | | 160 | 128 | | 1.3 | | | |
| IDF-Standard | 2 | 100 | 98 | 2" IDF | 79 | 30 | 0.8 | |
| | | 160 | 128 | 1.2 | | | | |
| APV-RJT-Standard | 2 | 100 | 92 | 2H x6" | 86 | 22 | 1.0 | |
| | | 160 | 122 | 1.4 | | | | |

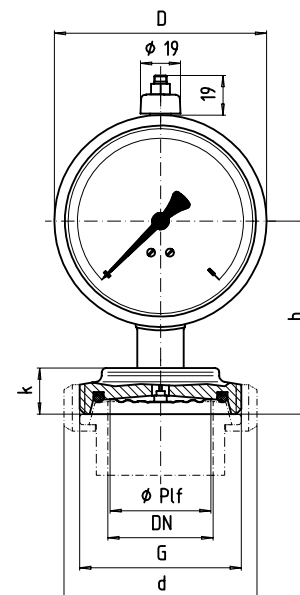

2223 520.01

Ordering information

State:

Model / Nominal size / Scale range / Process connection (Standard, size) / Options

Specifications and dimensions given in this leaflet represent the state of engineering at the time of printing. Modifications may take place and materials specified may be replaced by others without prior notice.



INGENIEROS ASOCIADOS DE CONTROL S.L.
Tel: 91 383 1390
comercial@iac-si.es