

Bimetal Thermometers

Domestic and Industrial Heating

Thermometers

Model 45

Service intended

Heating and plumbing

Nominal size

63, 80 and 100 mm

Temperature element

Coiled bimetal

Bulb

Stem with detaching thermowell (friction retained)

Working range

Maximum scale value

Pressure rating of thermowell

6 bar maximum



Standard features

Location of stem

Centre back

Case material

Aluminium

Connection

Thermowell G ½ A

Thermowell

Length l_1 = 40, 60 and 100 mm

Material Cu-alloy

Dial

White aluminium with black lettering

Pointer

Black aluminium

Window

Acrylic plastic

Zero adjustment

At bottom of stem

Optional extras

- Other scale ranges
- Scale other than °C
- Thread other than G ½ A

Special versions

Clip-on thermometer with fin and strap

63 and 80 mm

For sub-floor heater manifold

40 and 50 mm

Scale ranges

Scale range °C	Scale spacing °C
0 ... 60	1
0 ... 120	2

Models

Model	Nominal size	Location of stem / Connection
A 4500	63	Centre back
A 4501	80	
A 4502	100	
A 4550	63	Clip-on fin with strap
A 4551	80	

Dimensions

Location of stem: centre back

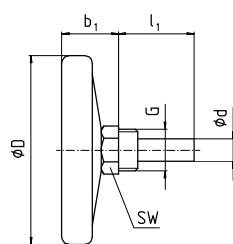

3072 932

Clip-on thermometer with fin and strap

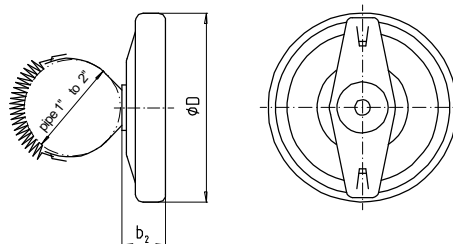

3072 940

Nominal size	Dimensions in mm							Weight in kg	
	b ₁	b ₂	Ø d	Ø D	G	l ₁	SW	centre back	clip-on
63	23	21	12 ¹⁾	63	G ½ A	40	21	0.065	0.040
80	25	22		80		60		0.080	0.060
100	30	-		100		100		0.105	-

1) Ø d = 11 mm with thermowell length l₁ ≥ 100 mm

Ordering information

State: Model / Nominal size / Scale range / Size of connection / Length of stem l₁ / Optional extras required



INGENIEROS ASOCIADOS DE CONTROL S.L.

Tel: 913831390
comercial@iac-sl.es