



Picture showing fitting Type SO05 Stainless Steel with pressure sensor/switch Type 8311

Our T-fitting SO05 can be used to connect any threaded sensor device for a measurement in the pipe. For example; indicators, sensors, switches, transmitters and controllers for easy flow, pressure and temperature control.

Process Specifications

Pipe diameter	1/2" up to 2"		
Sensor connection			
Internal threaded ports	G	1/2 up to G	2
	Rc	1/2 up to Rc	2
	NPT	1/2 up to NPT	2
Temperatures			
Ambient	-40°F up to 212°F		
Storage	-40°F up to 212°F		
Fluid	limited and depending on sensor		
Materials			
Seal	FPM (Viton)		
Fitting	316L Stainless Steel		
Adapter plate	316L Stainless Steel		
Pressure class	230 PSI (PN16)		

STAINLESS STEEL, T-Fitting

- ✓ Fitting adapted to whole Sensor Device Range
- ✓ Straight forward T-mounting

Applications: Insertion measurement in a pipe with threaded sensor devices

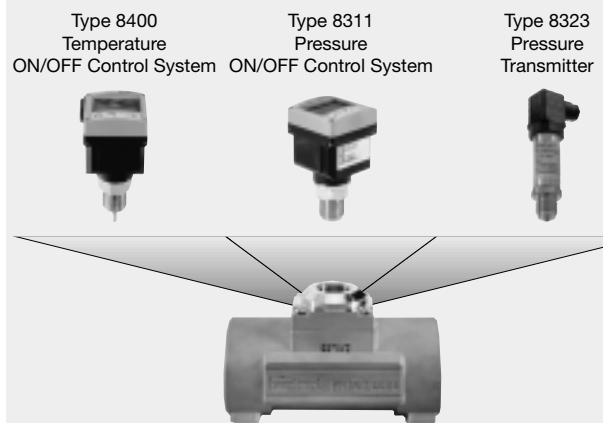

Dimensions [mm] for Fittings - Stainless Steel

Fitting with internal threaded port connection G, Rc and NPT 316L Stainless Steel

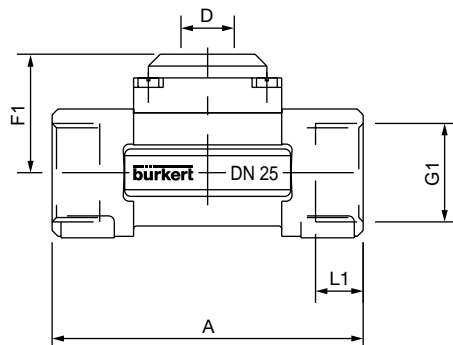

Orifice DN	Internal Threaded Port				
	A	G1	D	L1	F1
	[mm]			[mm]	[mm]
15	84.0	G 1/2	G 1/2, NPT 1/2, Rc 1/2	16.0	42.5
15	84.0	NPT 1/2		17.0	42.5
15	84.0	Rc 1/2		15.0	42.5
20	94.0	G 3/4		17.0	40.0
20	94.0	NPT 3/4		18.3	40.0
20	94.0	Rc 3/4		16.3	40.0
25	104.0	G 1		23.5	40.2
25	104.0	NPT 1		18.0	40.2
25	104.0	Rc 1		18.0	40.2
32	119.0	G 1 1/4		23.5	43.8
32	119.0	NPT 1 1/4		21.0	43.8
32	119.0	Rc 1 1/4		21.0	43.8
40	129.0	G 1 1/2		23.5	47.6
40	129.0	NPT 1 1/2		20.0	47.6
40	129.0	Rc 1 1/2		19.0	47.6
50	148.5	G 2		27.5	53.7
50	148.5	NPT 2		24.0	53.7
50	148.5	Rc 2		24.0	53.7



INGENIEROS ASOCIADOS DE CONTROL S.L.
Telf.: 91 3831390
comercial@iac-sles

Specifications - Ordering Chart (Other Versions on Request) for Type S005

Description	Orifice DN	Process Connection	Sensor Connection	Item No.
316L Stainless Steel Fitting World Wide				
• with internal threaded port connection				
Fitting with G 1/2 sensor connection	15	G 1/2	G 1/2	438 418 U
Fitting with G 1/2 sensor connection	20	G 3/4	G 1/2	438 419 V
Fitting with G 1/2 sensor connection	25	G 1	G 1/2	438 420 S
Fitting with G 1/2 sensor connection	32	G 1-1/4	G 1/2	438 421 P
Fitting with G 1/2 sensor connection	40	G 1-1/2	G 1/2	438 422 Q
Fitting with G 1/2 sensor connection	50	G 2	G 1/2	438 423 R
316L Stainless Steel Fitting ASIAN				
• with internal threaded port connection ISO 7(JIS)				
Fitting with Rc 1/2 sensor connection	15	Rc 1/2	Rc 1/2	438 442 U
Fitting with Rc 1/2 sensor connection	20	Rc 3/4	Rc 1/2	438 443 V
Fitting with Rc 1/2 sensor connection	25	Rc 1	Rc 1/2	438 444 W
Fitting with Rc 1/2 sensor connection	32	Rc 1-1/4	Rc 1/2	438 445 X
Fitting with Rc 1/2 sensor connection	40	Rc 1-1/2	Rc 1/2	438 446 Y
Fitting with Rc 1/2 sensor connection	50	Rc 2	Rc 1/2	438 447 Z
316L Stainless Steel Fitting NAFTA				
• with internal threaded port connection				
Fitting with NPT 1/2 sensor connection	15	NPT 1/2	NPT 1/2	438 430 U
Fitting with NPT 1/2 sensor connection	20	NPT 3/4	NPT 1/2	438 431 R
Fitting with NPT 1/2 sensor connection	25	NPT 1	NPT 1/2	438 432 J
Fitting with NPT 1/2 sensor connection	32	NPT 1-1/4	NPT 1/2	438 433 K
Fitting with NPT 1/2 sensor connection	40	NPT 1-1/2	NPT 1/2	438 434 L
Fitting with NPT 1/2 sensor connection	50	NPT 2	NPT 1/2	438 435 M

Burkert's Full Range of Fittings for Fluid Control Systems

					
Type of Fitting made of	SO01 <ul style="list-style-type: none">• Brass• Stainless Steel	SO05 <ul style="list-style-type: none">• Brass• Stainless Steel	SO10 <ul style="list-style-type: none">• Brass• Stainless Steel• Plastic	SO20 <ul style="list-style-type: none">• Brass• Stainless Steel• Plastic	SO30 <ul style="list-style-type: none">• Brass• Stainless Steel• Plastic
To be mounted with	<ul style="list-style-type: none">• 8002• 8302• 8308• 8310• 8311• 8320• 8323• 8324• 8400• or any other unit with G 1/2 sensor connection	<ul style="list-style-type: none">• 8002• 8302• 8308• 8310• 8311• 8320• 8323• 8324• 8400• or any other unit with G 1/2 sensor connection	<ul style="list-style-type: none">• SE10 (complete unit: 8010)	<ul style="list-style-type: none">• 8022• 8024• 8025• 8045• 8205• 8206• 8222• 8225• 8226	<ul style="list-style-type: none">• SE30 (complete unit: 8030)• SE32 (complete unit: 8032)• SE34 (complete unit: 8034)• SE35 (complete unit: 8035)
Advantages	Low Total Cost of Ownership	High flexibility with INLINE fittings	Closed pipe system (sensor inside fitting)	High flexibility with Insertion fittings (for large diameters)	Closed pipe system (sensor inside fitting)

For further information, e.g. diameters, process connections and item-numbers, please see type specific datasheets.



In case of special application requirements, please consult for advice.

INGENIEROS ASOCIADOS DE CONTROL S.L.
Telf.: 913831390
comercial@iac-sles

We reserve the right to make technical changes without notice.
US_SO05_SS_10/00